

Hope College

## Hope College Digital Commons

---

23rd Annual A. Paul and Carol C. Schaap  
Celebration of Undergraduate Research and  
Creative Activity (2024)

The A. Paul and Carol C. Schaap Celebration of  
Undergraduate Research and Creative Activity

---

4-12-2024

# What's My Social Distance? Measuring Individual Differences in Personal Space

Tasia Parsons  
*Hope College*

Tyler Kennedy  
*Hope College*

Erica Williams  
*Hope College*

Marella Piazza  
*Hope College*

Lauren Zago  
*Hope College*

Follow this and additional works at: [https://digitalcommons.hope.edu/curca\\_23](https://digitalcommons.hope.edu/curca_23)



Part of the [Psychology Commons](#)

---

### Recommended Citation

**Repository citation:** Parsons, Tasia; Kennedy, Tyler; Williams, Erica; Piazza, Marella; and Zago, Lauren, "What's My Social Distance? Measuring Individual Differences in Personal Space" (2024). *23rd Annual A. Paul and Carol C. Schaap Celebration of Undergraduate Research and Creative Activity (2024)*. Paper 50. [https://digitalcommons.hope.edu/curca\\_23/50](https://digitalcommons.hope.edu/curca_23/50)  
April 12, 2024. Copyright © 2024 Hope College, Holland, Michigan.

This Poster is brought to you for free and open access by the The A. Paul and Carol C. Schaap Celebration of Undergraduate Research and Creative Activity at Hope College Digital Commons. It has been accepted for inclusion in 23rd Annual A. Paul and Carol C. Schaap Celebration of Undergraduate Research and Creative Activity (2024) by an authorized administrator of Hope College Digital Commons. For more information, please contact [digitalcommons@hope.edu](mailto:digitalcommons@hope.edu), [barneycj@hope.edu](mailto:barneycj@hope.edu).

# What's my Social Distance?

## Measuring Individual Differences in Personal Space

Tyler Kennedy, Tasia Parsons, Marella Piazza, Erica Williams, Lauren Zago, Dr. Benjamin Meagher  
Hope College

For more information, contact  
Benjamin Meagher  
Hope College  
616-395-7731  
meagher@hope.edu  
Faculty Mentor

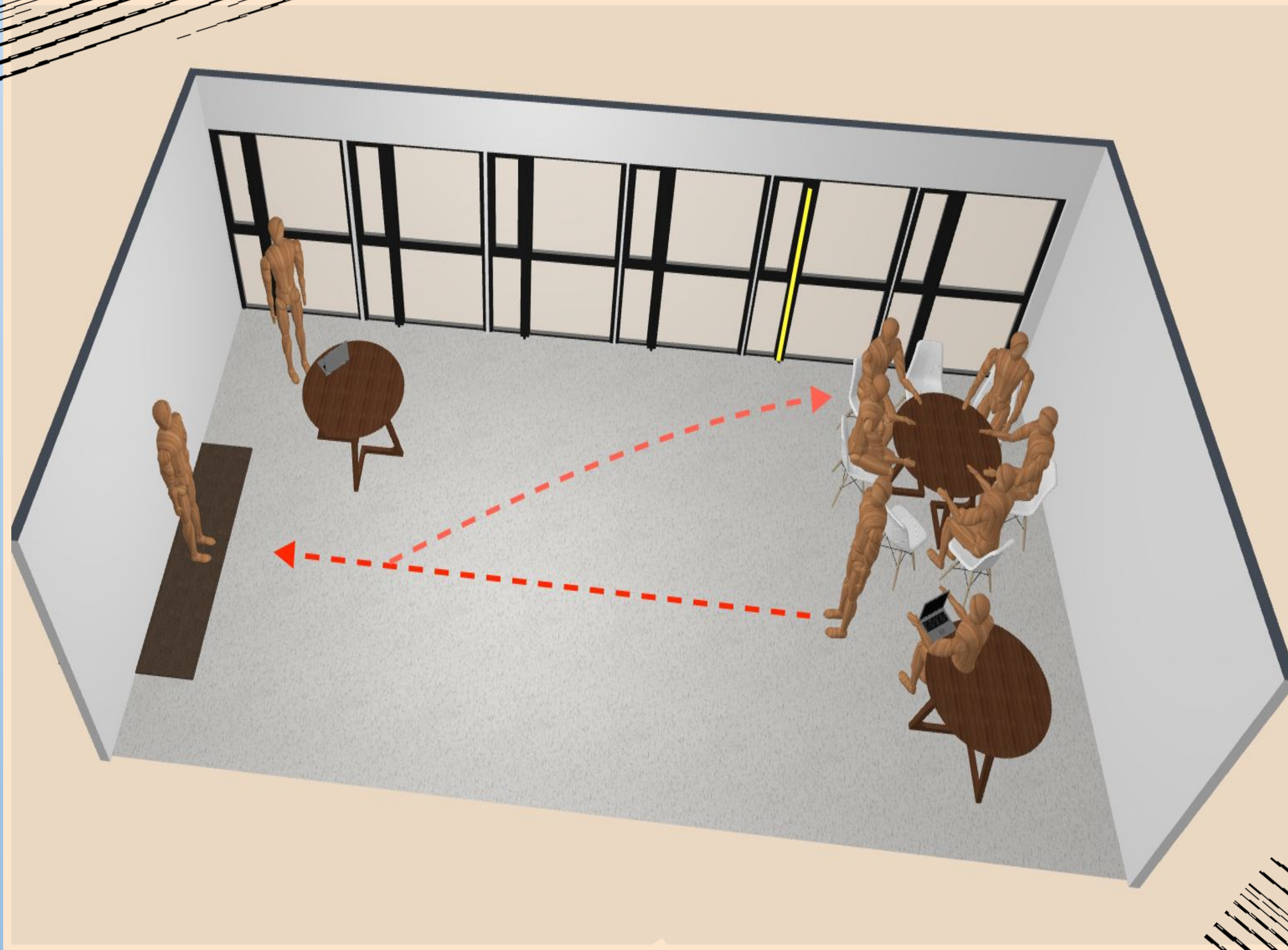

### What factors affect chosen personal space?

According to the social relations model (Kenny, 1994), dyadic interaction can be explained by three factors: **assimilation** (the tendency for some people to act the same with all other people), **consensus** (the tendency for all people to act the same towards some people), and **relationship** (the tendency for a particular person to act uniquely towards another particular person).

**The current study tests the relative impact of these factors on personal space preference.**

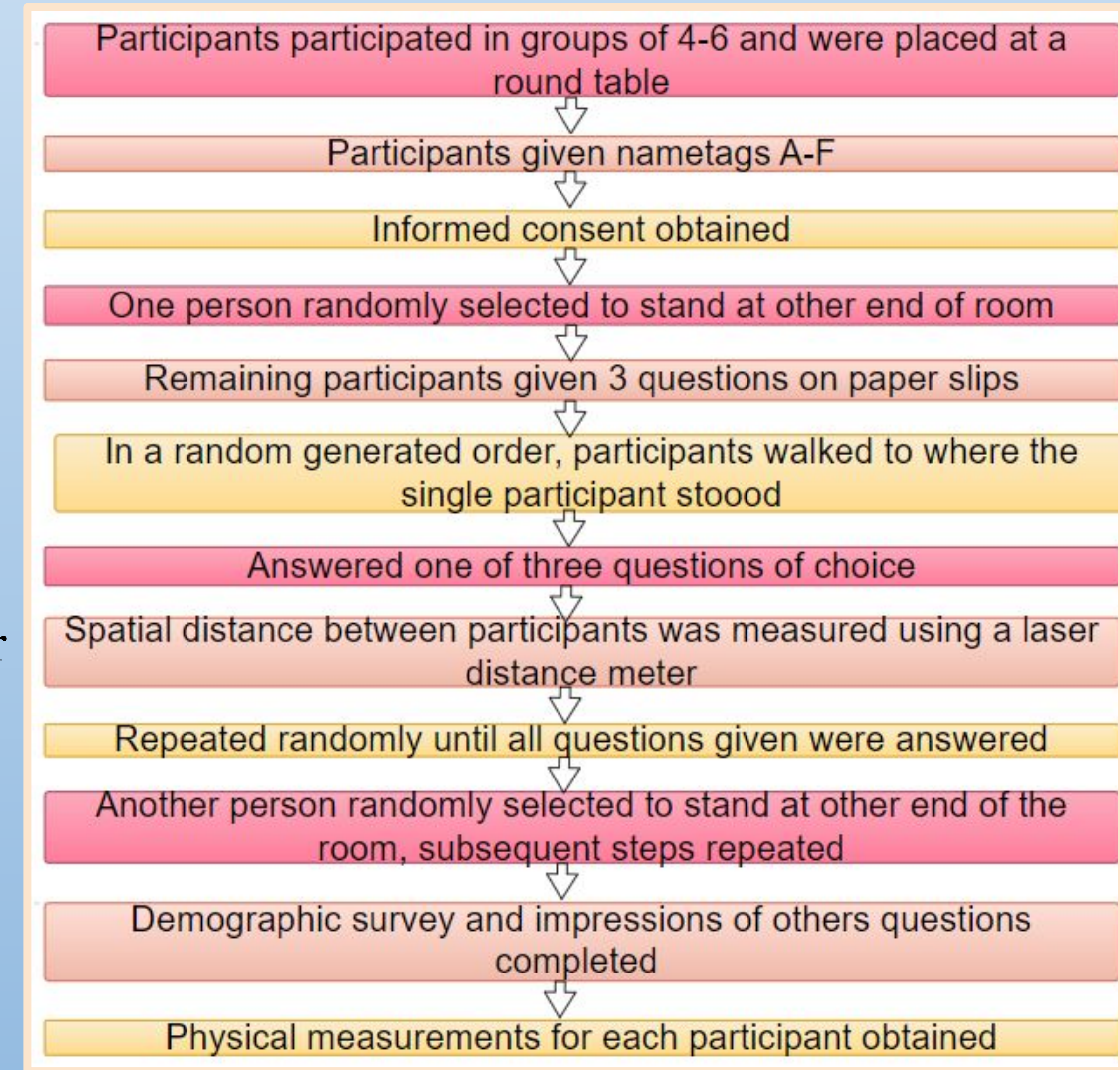

We recruited 67 participants through Hope College SONA, with the requirements that they be currently enrolled in a psych 100 level course. Each person received 1.5 SONA credits for participation.

We ran a multivariate regression to test what personality factors most predicted differences in preferred personal space. We found that the actor's own extraversion and their perception of the partner's attractiveness was associated with closer preferred distances.

We ran statistical analysis on the impressions of others survey, and found that relationship was the largest source of variance for warmth, morality and neuroticism. Consensus was the greatest for extraversion and assimilation was the greatest for personal space.

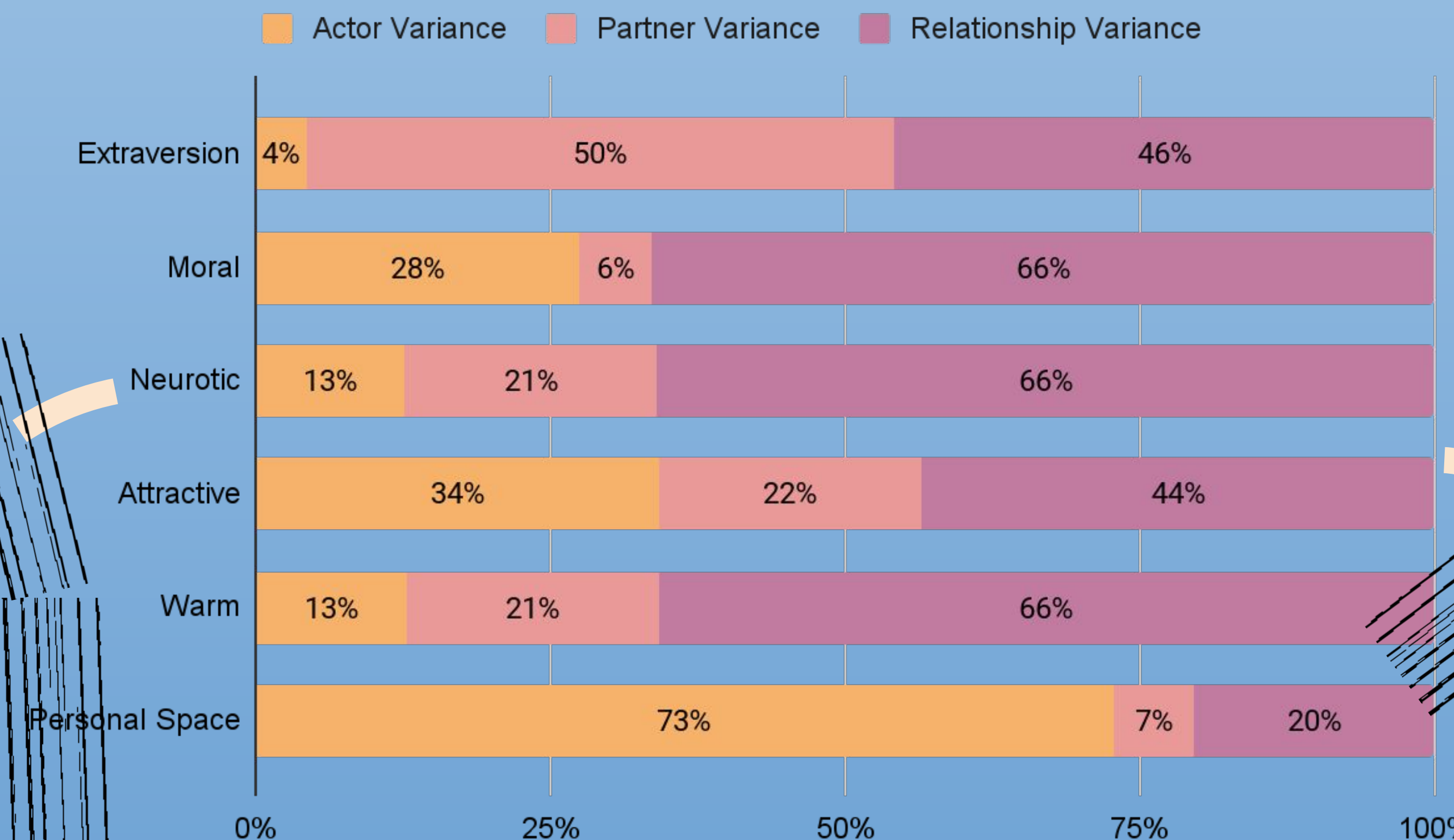

\*One group was omitted due to atypical patterns of behavior